

PRODUCT-DETAILS

# 463C6W

## 463C6W Industrial Connector

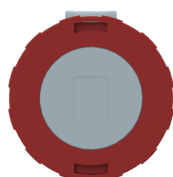

### Información General

Tipo de producto extendido	463C6W
Código de producto	2CMA166906R1000
EAN	7392696669061
Descripción corta	463C6W Industrial Connector
Descripción larga	Connector, earthing sleeve position 6h, rated current 63A, IP67 watertight, 3-poles+neutral+earth, frequency 50-60 Hz, color code Red

### Clasificación

E-Number (Sweden)	E2416418
E-Number (Finland)	2421743
E-Number (Norway)	1563883
EAN	7392696669061
Country of Origin	Czech Republic (CZ)
Cantidad mínima de pedido	1 piece

### Dimensiones

Ancho del product	108 mm
Alto del producto	112 mm
Peso del product	0.88 kg
Mechanical Drawings	9AKK107991A3984

## Información de Embalaje

Embalaje Nivel 1 Ancho	138 mm
Embalaje Nivel 1 Largo	158 mm
Embalaje Nivel 1 Alto	345 mm
Embalaje Nivel 1 Peso	0.88 kg
Embalaje Nivel 1 EAN	7392696669061
Embalaje Nivel 1 Unidades	box 1 piece
Package Level 2 Width	800 mm
Package Level 2 Depth / Length	1200 mm
Package Level 2 Height	900 mm
Package Level 2 Gross Weight	78.08 kg
Package Level 2 EAN	7392696070522
Package Level 2 Units	pallet (lift) 66 piece

## Ambiente

RoHS Status	Following EU Directive 2011/65/EU
-------------	-----------------------------------

## Certificados y Declaraciones (Número de Documento)

Declaración de conformidad - CE	2CMC700005D0001
Environmental Information	2CMC000056M0000
RoHS Information	2CMC700005D0001
SEMKO Certificate	1614200
REACH Declaration	2CMC700005D0001

## Información Adicional

Additional Information	3P+N+E
Ambient Temperature	-25 ... 40 °C
Cable Cross-Section	4 ... 16 mm <sup>2</sup>
Cable Diameter	17 ... 35 mm
Cable Entry Position	Cable entry, compression gland, internal and external cable clamp
Color	Red
Connection Type	Screw
Grado de protección	IP67 IP69
Frequency (f)	50 Hz 60 Hz
Function	Connector
Housing Material	Thermoplastic (PBT)
Invoice Description	Ind. P&S#463C6W
Number of Poles	5
Order Multiple	1 piece
Product Main Type	TC
Product Name	Industrial Connector
Protection Type	Watertight
Rated Current (I <sub>n</sub> )	63 A
Rated Voltage (U <sub>r</sub> )	200/346 ... 240/415 V
Recommended Screw Driver	PH2

Standards	IEC 60309-1, -2
Suitable For	Connectors
Suitable for Product Class	IEC Industrial Plugs and Sockets
Instrucciones y manuales	2CMC000038M0001
Installation Manual	2CMC000038M0001
RAL Number	RAL 7001 - Gris plata

---

## Clasificaciones

eClass	27440509
UNSPSC	39120000

---

## Technical

Wire Size	8 ... 4 AWG
Tightening Torque	WireClamp3.5 N·m

---

## Categorías

Productos y sistemas de baja tensión → Tomas de corriente industriales → Tough & Safe → Connectors

