

# Product datasheet

Specifications



## photo-electric sensor - XUX - multi - Sn 0..40m - 24..240VAC/DC - terminals

Local distributor code: 385301330 XUX0ARCTT16

EAN Code : 3389110168068

### Main

Range of product	Telemecanique Photoelectric sensors XU
Series name	General purpose multimode
Electronic sensor type	Photo-electric sensor
Sensor name	XUX
Sensor design	Compact 92 x 71
Detection system	Multimode
Material	Plastic
Type of output signal	Discrete
Supply circuit type	AC/DC
Wiring technique	5-wire
Discrete output function	1 NO or 1 NC programmable
Electrical connection	Screw-clamp terminals, 1 x 1.5 mm <sup>2</sup> or 1 x 0.75 mm <sup>2</sup> with adaptor
Product specific application	-
Emission	Infrared diffuse Infrared diffuse with background suppression Infrared thru beam Red polarised reflex
[Sn] nominal sensing distance	11 m polarised reflex need reflector XUZC50 40 m thru beam need a transmitter XUX0ARCTT16T 2 m diffuse 1.3 m diffuse with background suppression

### Complementary

Enclosure material	PBT
Lens material	PMMA
Maximum sensing distance	15 m polarised reflex 3 m diffuse 60 m thru beam 1.3 m diffuse with background suppression
Output type	Relay
Add on output	With alarm output, <= 100 mA with overload and short-circuit protection
Cable entry	1 entry for M16 x 1.5 cable gland, cable outer diameter: 7...10 mm
Status LED	1 LED (green) for supply 1 LED (red) for instability 1 LED (yellow) for output state

<b>[Us] rated supply voltage</b>	24...240 V AC/DC
<b>Switching capacity in mA</b>	0.5 A (cos $\phi$ = 0.4 for 0.5 million cycles at 1 operating cycle per second at 250 V) 3 A (cos $\phi$ = 1 for 0.5 million cycles at 1 operating cycle per second at 250 V)
<b>Switching frequency</b>	<= 20 Hz
<b>Maximum voltage drop</b>	<1.5 V (closed state)
<b>Maximum power consumption in W</b>	2 W AC/DC
<b>Time delay range</b>	0.02...15 s monostable, on-delay or off-delay (programmable) delay
<b>Maximum delay first up</b>	200 ms
<b>Maximum delay response</b>	25 ms
<b>Maximum delay recovery</b>	25 ms
<b>Setting-up</b>	Self-teaching
<b>Electrical durability</b>	500000 cycles, cos $f$ = 1, operating rate <60 cyc/mn at 250 V 500000 cycles, cos $f$ = 0.4, operating rate <60 cyc/mn at 250 V
<b>Depth</b>	77 mm
<b>Height</b>	92 mm
<b>Width</b>	31 mm
<b>Net weight</b>	0.2 kg

## Environment

<b>Product certifications</b>	UL CE CSA
<b>Ambient air temperature for operation</b>	-25...55 °C
<b>Ambient air temperature for storage</b>	-40...70 °C
<b>Vibration resistance</b>	7 gn, amplitude = +/- 1.5 mm (f = 10...55 Hz) conforming to IEC 60068-2-6
<b>Shock resistance</b>	30 gn (duration = 11 ms) conforming to IEC 60068-2-27
<b>IP degree of protection</b>	IP65 double insulation conforming to IEC 60529 IP67 double insulation conforming to IEC 60529

## Packing Units

<b>Unit Type of Package 1</b>	PCE
<b>Number of Units in Package 1</b>	1
<b>Package 1 Weight</b>	209.0 g
<b>Package 1 Height</b>	13.0 cm
<b>Package 1 width</b>	9.5 cm
<b>Package 1 Length</b>	4.0 cm
<b>Unit Type of Package 2</b>	P06
<b>Number of Units in Package 2</b>	176
<b>Package 2 Weight</b>	49.9 kg
<b>Package 2 Height</b>	45.0 cm
<b>Package 2 width</b>	60.0 cm
<b>Package 2 Length</b>	80.0 cm
<b>Unit Type of Package 3</b>	S02
<b>Number of Units in Package 3</b>	22

Package 3 Weight	5.119 kg
Package 3 Height	15.0 cm
Package 3 width	30.0 cm
Package 3 Length	40.0 cm

## Offer Sustainability

Sustainable offer status	Green Premium product
REACH Regulation	<a href="#">REACH Declaration</a>
EU RoHS Directive	Pro-active compliance (Product out of EU RoHS legal scope) <a href="#">EU RoHS Declaration</a>
Mercury free	Yes
RoHS exemption information	<a href="#">Yes</a>
China RoHS Regulation	<a href="#">China RoHS declaration</a>
Environmental Disclosure	<a href="#">Product Environmental Profile</a>
Circularity Profile	<a href="#">End of Life Information</a>

## Contractual warranty

Warranty	18 months
----------	-----------

**Dimensions**

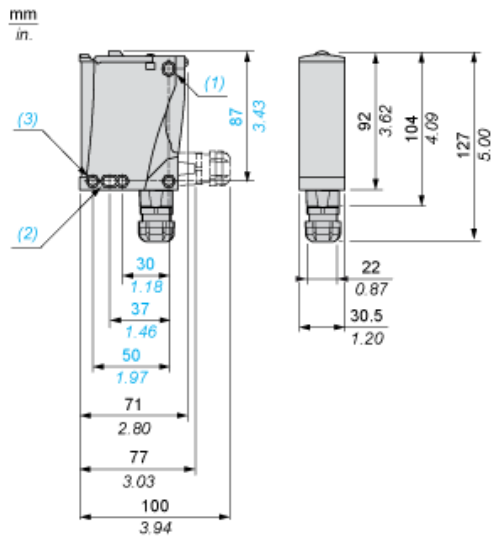

- (1) Elongated hole  $\varnothing$  5.5 x 7
- (2) Elongated hole  $\varnothing$  5.5 x 9
- (3)  $\varnothing$  5.5 hole

**Wiring Schemes**

---

**Relay Output AC/DC**

Terminals		
1		AC/DC
2		AC/DC
3		NO
4		Relay common
5		NC

**Detection Curves**

**With Thru-beam Accessory (Thru-beam)**

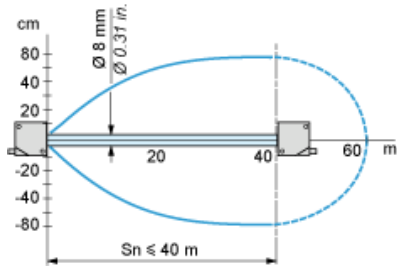

**Without Accessory (Diffuse)**

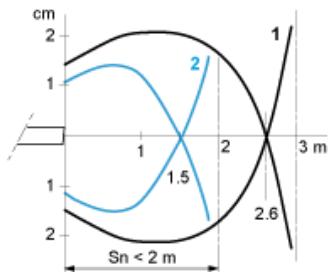

- 1 : White 90%
  - 2 : Grey 18%
- Object 10 x 10 cm

**Without Accessory (Diffuse with background suppression)**

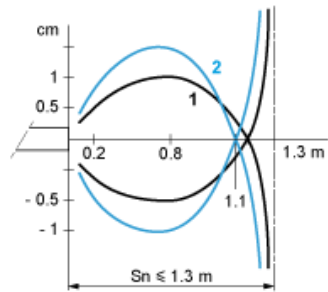

- 1 : White 90%
  - 2 : Grey 18%
- Object 10 x 10 cm

**With reflector (Polarised reflex)**

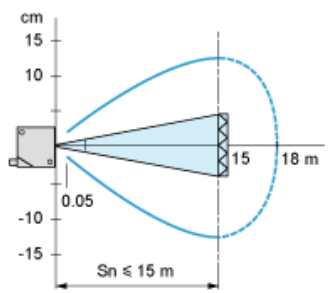

With reflector XUZC50

**Variation of Usable Sensing Distance Su (Without accessory, with adjustable background suppression)**

**Teach Mode at Minimum**

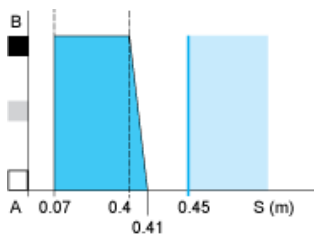

Teach Mode at Maximum

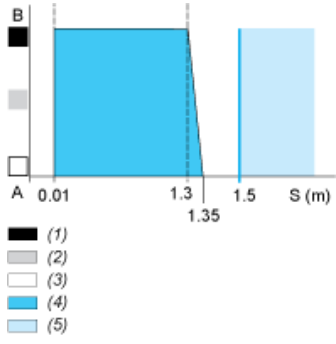

- A-B :** Object reflection coefficient  
(1) Black 6%  
(2) Grey 18%  
(3) White 90%  
(4) Sensing range  
(5) Non sensing zone (matt surfaces)