

FICHA TECNICA

Producto : Doble Velocidad (DAHLENDER)
 Marca : Salzer
 Modelo : S25-61213
 Amps : 25A
 Polos : 3
 Certificac. :    

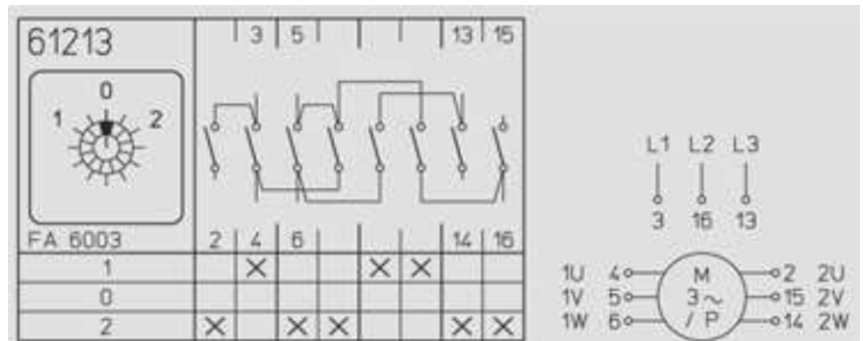

AC Rating Code	Unit	S25 RT25
Rated Operational Voltage(Ue)	V	690
Rated frequency	Hz	50/60
Rated impulse withstand Voltage(Uimp)	Kv	6
Rated Operational Current(Ie) AC21/AC1	A	25
Rated Uninterrupted Current (Ith)	A	32
Rated Operational Power		
AC23A "3 Ph , 415 V"	KW	11
	A	19
AC3	KW	7.5
"3 Ph , 415 V"	A	13
Short Circuit Capacity		
Rated Fuse Short Circuit Current	KA	10
Fuse Size (Type gG/gM)	A	25
Terminal Cross Section		
Single / Multiple	min	mm ² 1.5
	max	mm ² 4
Fine strand	min	mm ² 1
	max	mm ² 2.5
Terminal Cross Section	Metric	M4
Terminal Tightening Torque	Nm	1.2

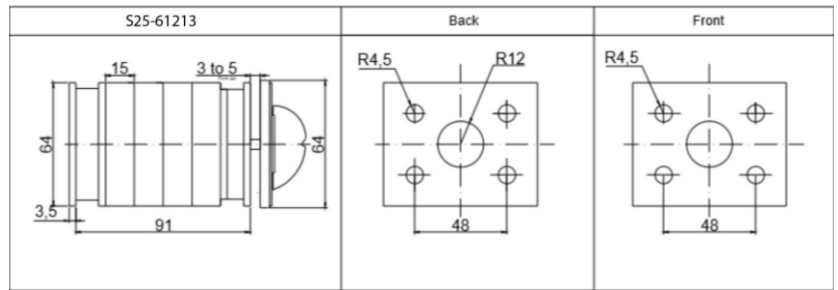

CSA/UL Ratings

AC Rating Code	Unit	S25 RT25
Ampere Rating	A	20
Operational Voltage	V	600
HP Rating 1 Phase	HP	1.5
240V	HP	3
3 Phase	HP	3
240V	HP	7.5
480V	HP	10
600V	HP	15

