

FICHA TECNICA

Producto	:	Doble Velocidad (DAHLENDER)
Marca	:	Salzer
Modelo	:	S40-61213
Amps	:	40A
Polos	:	3
Certificac.	:	

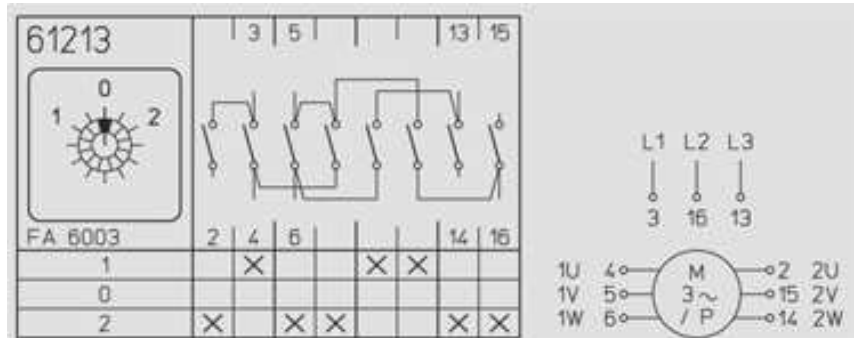

AC Rating Code	Unit	S40	RT40
Rated Operational Voltage(Ue)	V	690	
Rated frequency	Hz	50/60	
Rated impulse withstand Voltage(Uimp)	Kv	6	
Rated Operational Current(Ie) AC21/AC1	A	40	
Rated Uninterrupted Current (Ith)	A	50	
Rated Operational Power			
AC23A "3 Ph , 415 V"	KW	18.5	
	A	32	
AC3	KW	15	
"3 Ph , 415 V"	A	26	
Short Circuit Capacity			
Rated Fuse Short Circuit Current	KA	20	
Fuse Size (Type gG/gM)	A	40	
Terminal Cross Section			
Single / Multiple	min	mm ²	2.5
	max	mm ²	10
Fine strand	min	mm ²	2.5
	max	mm ²	6
Terminal Cross Section		Metric	M5
Terminal Tightening Torque		Nm	2

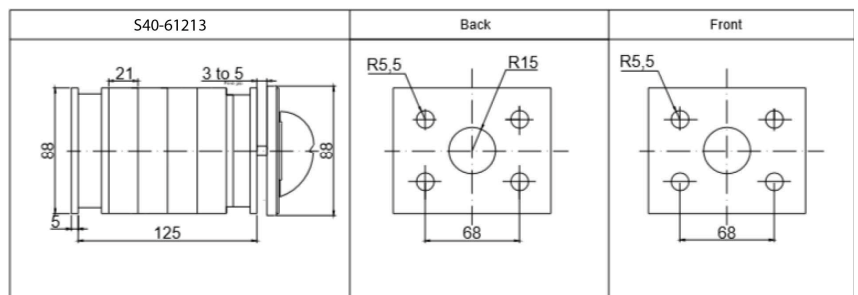

CSA/UL Ratings

AC Rating Code	Unit	S40
Ampere Rating	A	40
Operational Voltage	V	600
HP Rating 1 Phase 120V	HP	2
240V	HP	5
3 Phase 120V	HP	5
240V	HP	10
480V	HP	20
600V	HP	24

