



# Exhaust filter series

Optional parts

## Characteristics

- Frame material uses anti-flame and heat resisting ABS plastic, of which fire resistance are accord with UL-94 Vo standard.
- Installation without screws are accord with standard of VDE 0113(EN 60204)
- Optional equips polyester fiber filter pad of 100g/ .150g/ .350g/ , built-in standard is 150g/ .Standard max static pressure 86Pa 62Pa max relative humidity 90%.
- Temperature range : (unconcretionary) -20 ~ +65 (store temperature) -20 ~ +70

- ABS UL-94 Vo
- VDE 0113(EN 60204)
- 100g/m2. 150g/m2. 350g/m2. 150g/m2
- 86Pa 62Pa 90%
- -20 ~+65 -20 ~+70

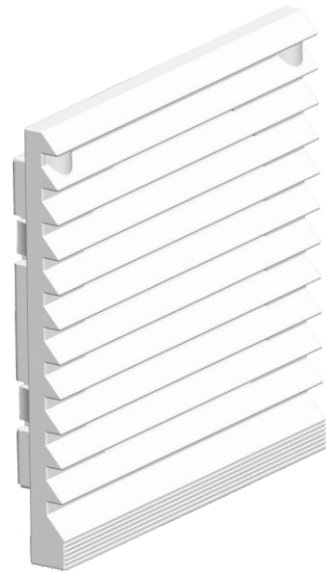
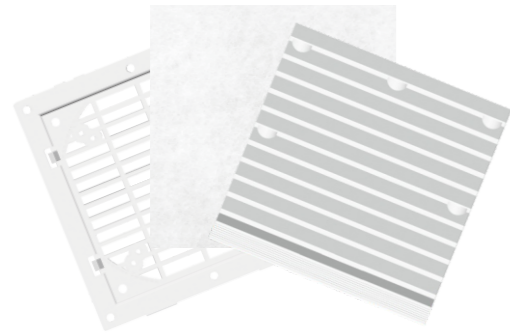

## Outline Dimensions

Units: mm

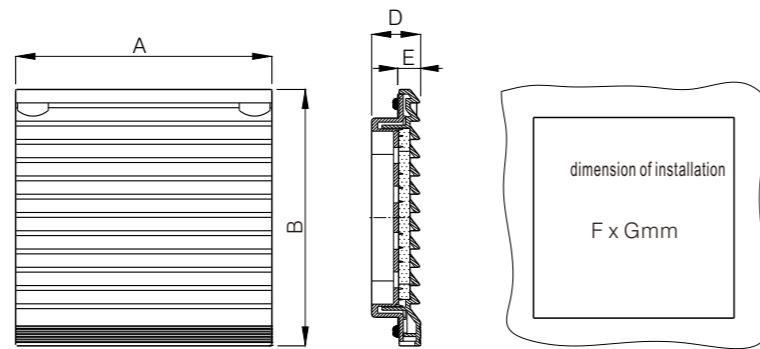

Type	External dimensions				Opening size		IP	Filter pat		Related Info page
	A	B	D	E	F	G		level	Size	
RAL 7035										
JK 6620	106.5	106.5	22	10	82.5	82.5	54	G2	75x75	91/92
JK 6621	116.5	116.5	22	10	93	93	54	G2	85x85	93/94
JK 6622	148.5	148.5	27.5	10	122.5	122.5	54	G2	115x115	95/96
JK 6623	204.5	204.5	30	13.5	176	176	54	G2	170x170	97/98
JK 6625	255	255	30.5	13.5	222	222	54	G2	215x215	99/100
JK 6626	324	324	30.5	13.5	290	290	54	G2	285x285	101/102
JK 6626D	324	324	30.5	13.5	290	290	54	G2	288x288	103/104



Ventilation shutter  
Built-in black filter sponge  
Finger guard for axial fan

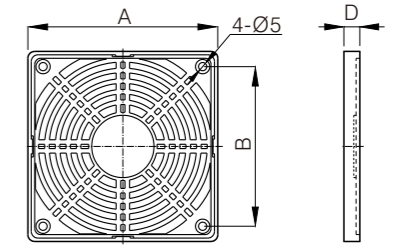

Type	External dimensions		
	A	B	D
LP 4008	8.6	71.5	10
LP 4009	9.6	82	10
LP 4012	115	104.8	10.5

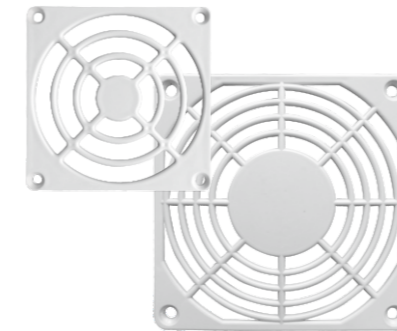

ABS plastic guard  
Color RAL 7035

ABS  
RAL 7035

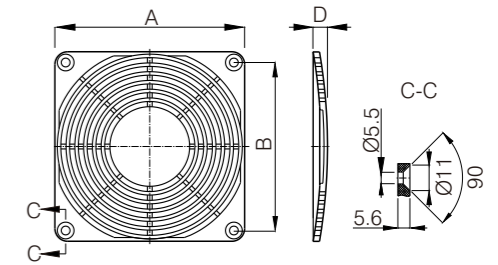

Type	External dimensions		
	A	B	D
LP 4208	80	71.5	7
LP 4209	92	82	7
LP 4212	120	104.8	6.5

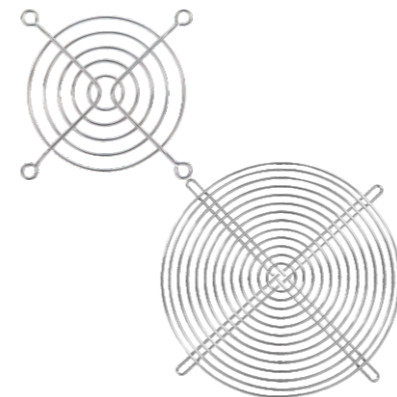

Metal guard  
Surface nickel plating  
Better corrosion resistance

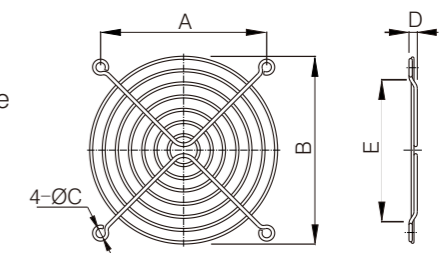

Type	External dimensions				
	A	B	C	D	E
LP 2204	32	29.5	4.5	4.5	35
LP 2206	50	53	5	5	57
LP 2208	71.5	73	5.3	5	85
LP 2209	82	87	5.3	5.4	102
LP 2212	104.8	115.5	5.5	5.4	133
LP 2215	114.5	140	5.5	5.4	152
LP 2222	170	215.5	5.5	9.5	209
LP 2225	208.6	268	6.6	11.5	257